

SANCTIONED

To be read in conjunction with
memo No. 19841 Dtd. 11-08-2017

Checked and found ok for Public Health
(Internal) Services only subject to comments in
in forwarding letter No. SE(HQ)/.../29.11/11
12.02.09

Superintending Engineer (HQ)
HUDA, Panchkula.

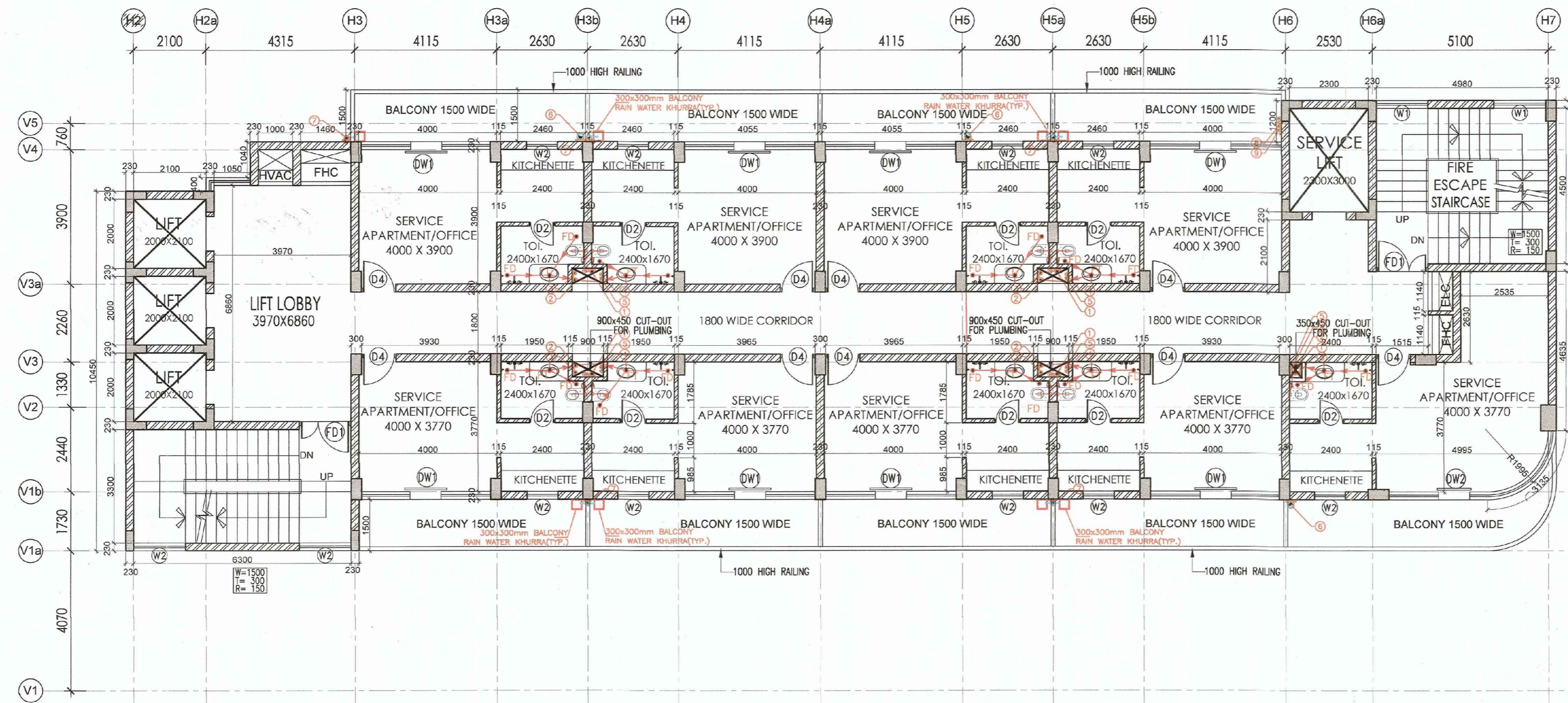

OPENING SCHEDULE			
TYPE	SIZE	C. LVL	L. LVL
D1	650X2000	+100	+2100
D2	750X2000	±000	+2100
D3	900X2100	±000	+2100
D4	1000X2400	±000	+2400
W1	1000X2400	+900	+2400
W2	1000X1200	+1200	+2400
V1	1200X600	+2100	+2700
FD1	1500X2400	±000	+2400
FD2	1050X2400	±000	+2400
FD3	1800X2400	±000	+2400
DW1	3745X2400	±000	+2400
DW2	5635X2400	±000	+2400
DW3	2800X2400	±000	+2400

SUBMISSION DRAWING

REVISED BUILDING PLAN OF
COMMERCIAL COLONY MEASURING
3.556 ACRES (LICENCE NO-48 OF
2008 DATED 14/03/2008,) IN
SECTOR-83, GURGAON MANESAR
URBAN COMPLEX BEING DEVELOPED
BY M/s KLJ REALTECH PVT. LTD.

LEGEND:

S.NO	SYMBOL	DESCRIPTION
1.	①	100Ø SOIL PIPE HCl
2.	Ⓐ	150Ø SOIL PIPE HCl
3.	②	100Ø WASTE PIPE HCl
4.	Ⓐ	150Ø WASTE PIPE HCl
5.	③	75Ø ANTISYPHONAGE PIPE HCl
6.	④	COLD WATER SUPPLY PIPE
7.	⑤	FLUSHING WATER SUPPLY PIPE
8.	⑥	150Ø RAIN WATER PIPE
9.	⑦	100Ø BALCONY RAIN WATER PIPE
10.	⑧	COLD WATER RISER PIPE
11.	⑨	FLUSHING WATER RISER PIPE
12.	FD	FLOOR DRAIN
13.	FT	FLOOR TRAP
14.	—	WASTE PIPE LINE
15.	—	SOIL PIPE LINE
16.	■	300X300mm BALCONY RAIN WATER KHURRA
17.	■	450X450 TERRACE RAIN WATER KHURRA
18.	⊙	FLOOR CLEAN OUT
19.	⊞	CLEAN OUT PLUG

4TH FLOOR	LVL.+16650
5TH FLOOR	LVL.+20250
7TH FLOOR	LVL.+27450
8TH FLOOR	LVL.+31050
10TH FLOOR	LVL.+38250

NOTES:-

- ALL BUILDING FULLY SPRINLERED AS PER N.B.C. NORMS. CENTRALLY AIR CONDITIONED AND
- ALL BUILDING ARE MECHANICALLY LIGHTED AND VENTILATED AS PER N.B.C. NORMS.
- 100 % POWER BACKUP PROVIDED

S.T.P. (HQ) Member Secretary
S.T.P. (G) Member B.P.C.
C.T.P. (Hr) Chairman B.P.C.

For KLJ Realtech Private Limited

Authorized Signatory

(BALWANT SINGH)
S.D.

SA
SIKKA ASSOCIATES ARCHITECTS
URBAN DESIGN | MASTERPLAN | ARCHITECTURE | INTERIORS | ENGINEERING | PROJECT MANAGEMENT
A-21, AFRICA AVENUE, SAFDARJUNG ENCLAVE, NEW DELHI-110 029, INDIA
T: +91.11.4323 8236 | F: +91.11.2629 4481 | E: saas@saasindia.net | W: www.saasindia.net

ARCHITECT: raman sikka
REGN. No. 03/16497

OWNER: [Signature]

SCALE: 1:100

DATE ISSUED: [Blank]

DRAWN BY: NAVIN DEO

CHECKED BY: SSB

DRAWING: SERVICE APARTMENTS/OFFICES
TYPICAL FLOOR PLAN
(4TH, 5TH, 7TH, 8TH & 10TH) TOWER-A

DWG NO. SUB/KLJ/ 07