

S.P. (H.O. CM) Member Secretary B.P.C.  
 S.P. (G) Member B.P.C.  
 S.P. (H.K.) Chairman B.P.C.

**SANCTIONED**

To be read in conjunction with memo No. 19341/11-02-2017.  
 (BALVANT SINGH) S.D.  
 For KLJ Realtech Private Limited  
 Authorized Signatory

Checked and found ok for Public Health (Internal) Service only subject to conditions in forwarding letter No. SE/12-03-2017  
 Superintending Engineer (HO) HUDA, Patancheru.

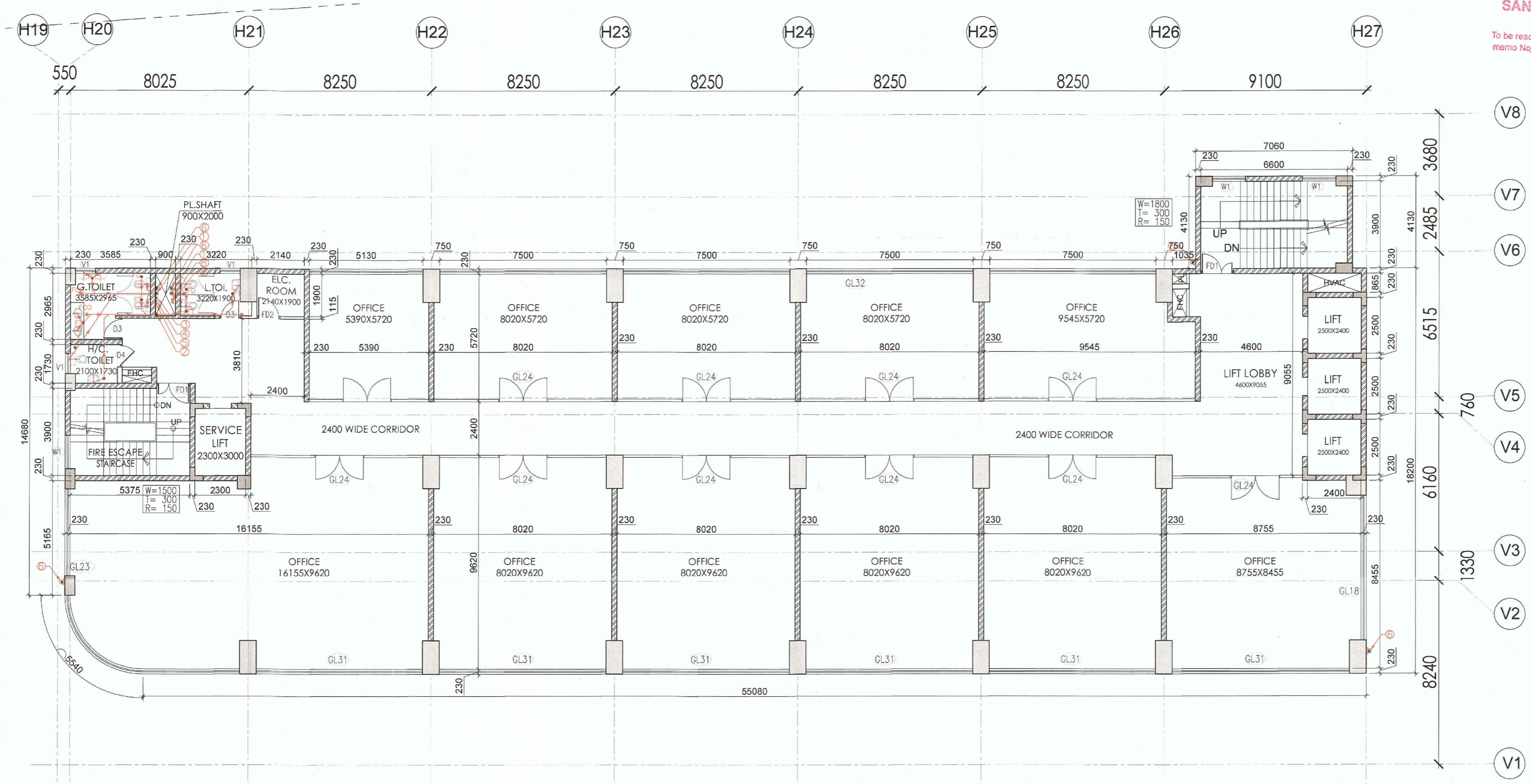

TYPE	SIZE	C. LVL	L. LVL
D1	650X2000	+100	+2100
D2	750X2000	+1000	+2100
D3	900X2100	+1000	+2100
D4	1000X2400	+1000	+2400
W1	1000X2400	+900	+2400
W1	1200X600	+2100	+2700
FD1	1500X2400	+1000	+2400
FD2	1050X2400	+1000	+2400
FD3	1800X2400	+1000	+2400
RS1	3000X3000	+1000	+3000
GL.1	7970X3850	+1000	+3850
GL.2	6900X3850	+1000	+3850
GL.3	5665X3850	+1000	+3850
GL.4	8625X3850	+1000	+3850
GL.5	7480X3850	+1000	+3850
GL.6	8365X3850	+1000	+3850
GL.7	13800X3850	+1000	+3850
GL.8	5085X3850	+1000	+3850
GL.9	2835X3850	+1000	+3850
GL.10	6245X3850	+1000	+3850
GL.11	4220X3850	+1000	+3850
GL.12	3975X3850	+1000	+3850
GL.13	3895X3850	+1000	+3850
GL.14	9135X3850	+1000	+3850
GL.15	3665X3850	+1000	+3850
GL.16	17545X3850	+1000	+3850
GL.17	7400X3850	+1000	+3850
GL.18	7900X3850	+1000	+3850
GL.18A	3765X3850	+1000	+3850
GL.19	4070X3850	+1000	+3850
GL.20	16545X3850	+1000	+3850
GL.21	3040X3850	+1000	+3850
GL.22	4500X3850	+1000	+3850
GL.23	10365X3850	+1000	+3850
GL.24	5350X3850	+1000	+3850
GL.25	8475X3850	+1000	+3850
GL.26	4375X3850	+1000	+3850
GL.27	10370X3850	+1000	+3850
GL.28	10370X3850	+1000	+3850
GL.28	10645X3850	+1000	+3850
GL.30	55375X3850	+1000	+3850
GL.31	60600X3850	+1000	+3850
GL.32	46170X3850	+1000	+3850

**LEGEND:**

S.NO	SYMBOL	DESCRIPTION
1.	100	100# SOIL PIPE HCl
2.	150	150# SOIL PIPE HCl
3.	100	100# WASTE PIPE HCl
4.	150	150# WASTE PIPE HCl
5.	75	75# ANTISYPHONAGE PIPE HCl
6.	4	COLD WATER SUPPLY PIPE
7.	5	FLUSHING WATER SUPPLY PIPE
8.	150	150# RAIN WATER PIPE
9.	100	100# BALCONY RAIN WATER PIPE
10.	4	COLD WATER RISER PIPE
11.	5	FLUSHING WATER RISER PIPE
12.	FD	FLOOR DRAIN
13.	FT	FLOOR TRAP
14.	---	WASTE PIPE LINE
15.	---	SOIL PIPE LINE
16.	---	300X300 BALCONY RAIN WATER KHURRA
17.	---	450X450 TERRACE RAIN WATER KHURRA
18.	---	FLOOR CLEAN OUT
19.	II	CLEAN OUT PLUG

4TH FLOOR	LVL.+17850
5TH FLOOR	LVL.+21750
6TH FLOOR	LVL.+25650
7TH FLOOR	LVL.+29550
8TH FLOOR	LVL.+33450

**SUBMISSION DRAWING**

REVISED BUILDING PLAN OF COMMERCIAL COLONY MEASURING 3.556 ACRES (LICENCE NO-48 OF 2008 DATED 14/03/2008,) IN SECTOR-83, GURGAON MANESAR URBAN COMPLEX BEING DEVELOPED BY M/s KLJ REALTECH PVT. LTD.

**SAA**  
 SIKKA ASSOCIATES ARCHITECTS  
 42/1, AFRICA AVENUE, SAFDARJUNG ENCLAVE, NEW DELHI-110028, INDIA  
 T: +91 11 4263 5295 | F: +91 11 2629 4461 | E: saas@saasarch.com | W: www.saasarch.com

ARCHITECT: *Raman Sikka*  
 OWNER: *Raman Sikka*  
 REGN. No. 03/16497

SCALE: 1:100  
 DATE ISSUED:  
 DRAWN BY: NAVIN DEO  
 CHECKED BY: SSB

TOWER-B OFFICES TYPICAL FLOOR PLAN (4TH, 5TH, 7TH, 8TH)  
 DWG. NO.: SUB/KLJ/ 09

- NOTES:-**
- ALL BUILDING FULLY SPRINKLERED AS PER N.B.C. NORMS.
  - ALL BUILDING ARE MECHANICALLY LIGHTED AND VENTILATED AS PER N.B.C. NORMS.
  - 100 % POWER BACKUP PROVIDED